



Baldocks Road, Epping, CM16

BUTLER  STAG



Situated in the heart of Theydon Bois is this stunning two bedroom semi-detached bungalow.



Freehold

- Semi Detached Bungalow
- Two Bedrooms
- Two Reception Rooms
- Off-Street Parking
- Central Village Location
- 88' Rear Garden

The property has been maintained to a very good standard throughout by its current owners and offers good living space. Accommodation consists of a large formal living/dining room, a kitchen breakfast room, and a shower room.

Externally, the property boasts generous off street parking via the block paved driveway, side access and a beautifully landscaped 'low maintenance' rear garden with patio and ample amounts of outside storage.

Baldocks Road is a much sought after turning in the ever popular village of Theydon Bois. The village is arranged around the green and offers a parade of shops, several pubs and restaurants and easy access into Epping Forest. Transport links into London are excellent. Theydon Bois underground station is in walking distance and there are several well regarded state and private schools within easy reach. Local leisure facilities include golf courses, sports centres and a tennis club.

Council- Epping Forest
Tax Band- E





Baldocks Road, CM16

Approx. Gross Internal Area 829 Sq Ft - 77.01 Sq M
Approx. Gross Garage Area 174 Sq Ft - 16.16 Sq M

BUTLER & STAG

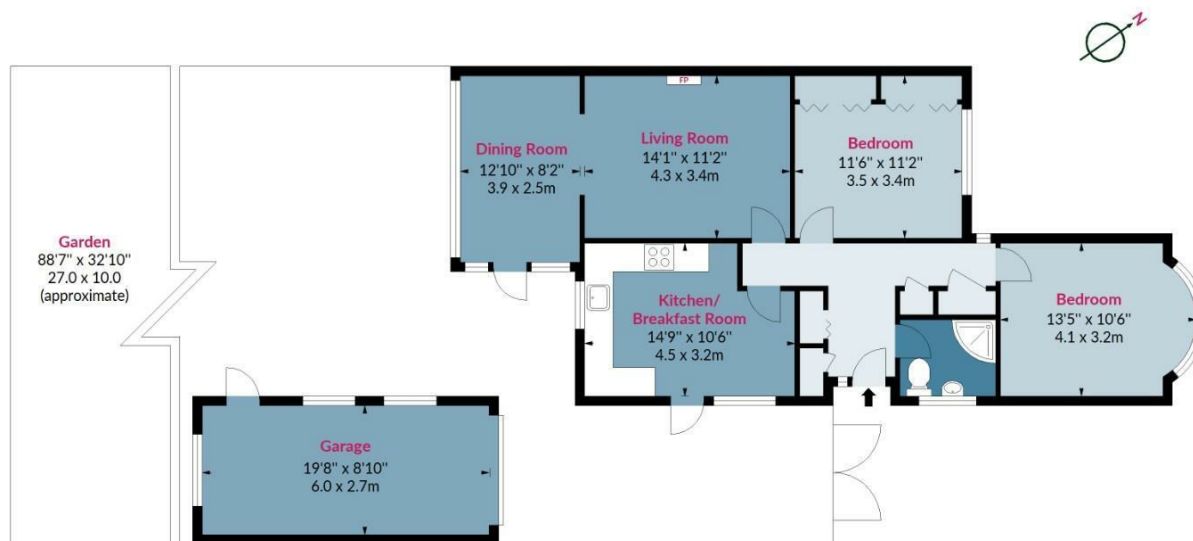

Ground Floor

Floor Area 829 Sq Ft - 77.01 Sq M



Measured according to RICS IPMS2. Floor plan is for illustrative purposes only and is not to scale. Every attempt has been made to ensure the accuracy of the floor plan shown, however all measurements, fixtures, fittings and data shown are an approximate interpretation for illustrative purposes only. 1 sq m = 10.76 sq feet.

lpaplus.com

Date: 28/9/2022

BUTLER & STAG

☎ 01992 667666

🏠 4 Forest Drive, Theydon Bois, Essex, CM16 7EY

✉ theydon@butlerandstag.com

www.butlerandstag.uk

IMPORTANT NOTICE - These particulars have been prepared in good faith and they are not intended to constitute part of an offer or contract. We have not performed a structural survey on this property and the services, appliances and specific fittings have not been tested. All photographs, measurements, floor plans and distances referred to are given as a guide and should not be relied upon.